



D100 User Guide / D100 Manuel de l'Utilisateur

Description of Functions / Description de Operation

1. Charging separation: When the customer picks up the cell phone, the stand will stop charging, after putting it back, it will continue to charge again.

Chargement: Quand le téléphone est ramassé, la station va arrêter de charger. Après le téléphone est replacer la station vas commencer à charger encore.

2. High security: Alarming on the sensor head; supporting 4-point metal clamps.

Sécurité: L'alarme sur le haut de la station. 4-point de sécurité en métal.

Installation Steps / Etapes d'Installation

1. Connect the power cable to the power adaptor; connect the adaptor to the power.

Connecter le câble pour charger à l'adaptateur, connecter l'adaptateur au l'électricité.

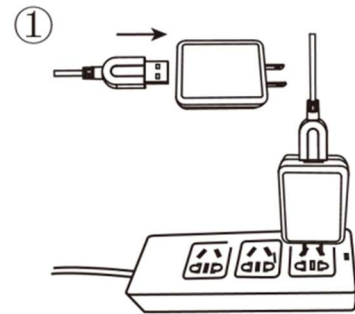

2. Tear the base sticker or use wing screw nut to fix the base on the tabletop.

Enlever le ruban adhésif de la base ou l'utilise vise et écrou à ailettes pour attacher à la table.

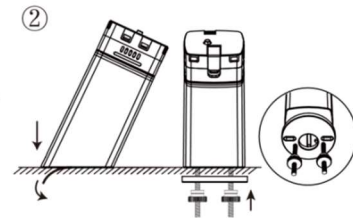



3. Open the Switch on the up head.

Ouvrir l'interrupteur en haut de la station.

③

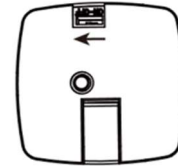

4. Connect the phone charging cable.

Connecter le câble de chargement.

④

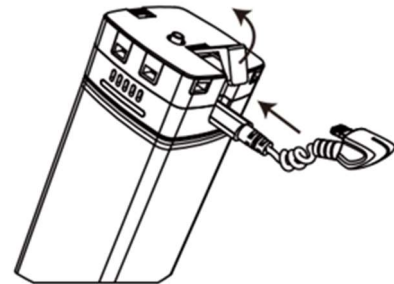

5. Tear off the film adhesive tape and stick the cell phone on the sensor head; Connect the charging cable with phone.

Enlever le ruban adhésif et coller le téléphone en haut de la station. Connecter le câble de chargement au téléphone.

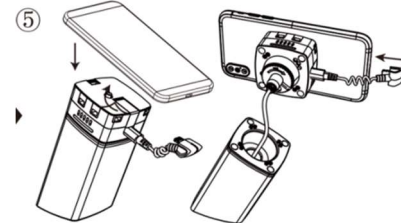

6. Loosen the screws for the four clamps.

Desserrer les quatre vis pour les pinces.

⑥

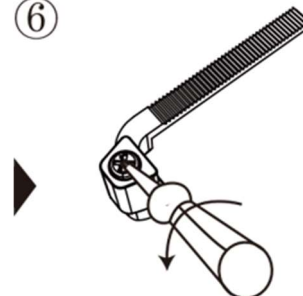



7. Install the clamps four sides, and lock the screw on the up head. (Note: four clamps must be installed as shown.)

Installer les quatre pinces et serrer les vis sur la tête de la station. (Note : les quatre pinces devraient être installées comme montré dans l'image.)

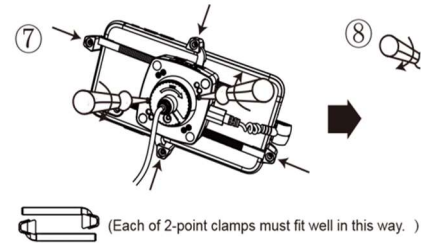

8. Install the upper and lower clamps and lock the screws.

Installer les pinces plus haut et plus bas et serrer les vis.

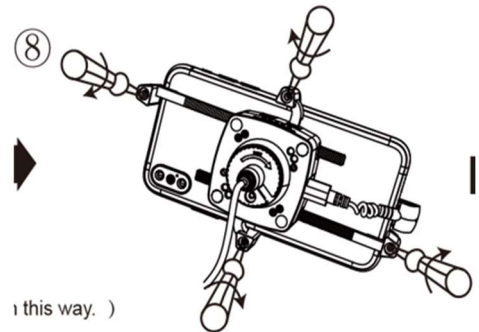

9. Activate the anti-theft stand by pressing "activating" button on the remote control.

Mettre l'alarme par cliquer le bouton "activer" sur la télécommande.

Activating alarm

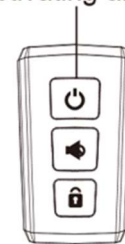



Collect Cellphone / Collecter Telephone

Loosen the screw with a screwdriver; unscrew the cover plate counter clockwise. Then take away cellphone from head stand.

Desserrer le vise avec un tournevis; dévisser la couverture par tourner antihoraire. Enlever le téléphone de la station.

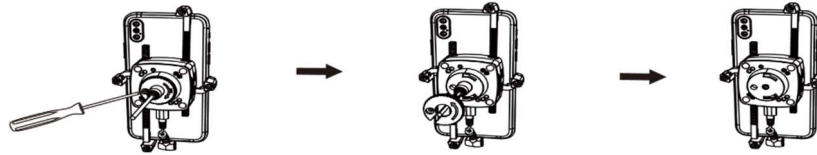

Alarm Case / L'alarme

1. Alarm when loosening the switch tamper on the top head

L'alarme sonne quand desserrer l'interrupteur en haut de la station

2. Alarm when pulling out the charging cable.

L'alarme sonne quand tirer le câble de chargement

3. Alarm when top head Disassembled.

L'alarme sonne quand démonter la tête de la station.

4. Alarm when unplugging stand

L'alarme sonne quand débrancher la station

5. Alarm when cutting the charging cable.

L'alarme sonne quand couper le câble de chargement.

6. Alarm when lifting bottom of stand.



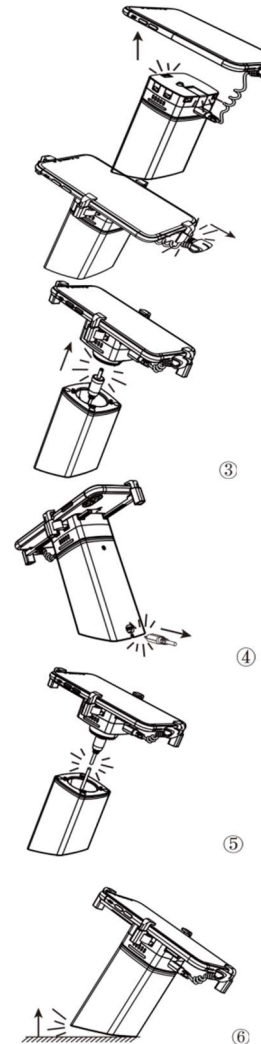

L'alarme sonne quand lever le bas de station.





Product Components / Les Pièces du Produit

| No. | Item | Quantity | Out Put | Size(mm) |
|-----|---|----------|------------|-----------------|
| 1 | Alarm Device / <i>Appareil d'Alarme</i> | 1 pcs | 5.7V 2A | 57 x 51.5 x 109 |
| 2 | Screws / <i>Vise</i> | 2 pcs | / | / |
| 3 | Screwdriver / <i>Tournevis</i> | 1 pcs | / | / |
| 4 | Power Adaptor 5.7V 2A / <i>L'Adapteur 5.7V 2A</i> | 1 pcs | 5.7V 2A | 35 x 23 x 47 |
| 5 | Base Fixture / <i>Base Pour Fixer La Station</i> | 1 pcs | / | Ø56 x 5 |

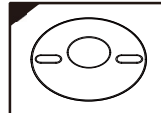
| | | | | |
|---|---|---|--|---|
|  |  |  |  |  |
|---|---|---|--|---|